

Angular Contact Ball Bearings

Brass cage angular contact ball bearing-7314 BECBY

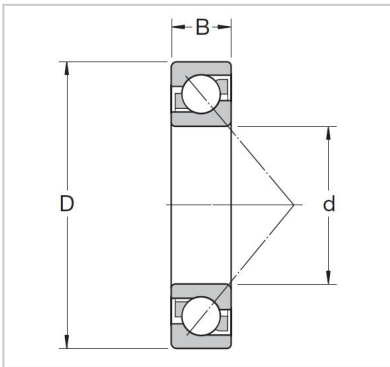

Abutment and fillet dimensions

Db max.	7314 BECBY
Da max.	7314 BEP
da min.	70
rb max.	150
ra max.	35

Dimensions

a	119
r3,4 min.	90
r1,2 min	3.65
D1	5 300
d2	5 300
d1	2.65

Mass

KG	101
----	-----

Speed ratings r/min

Limiting speed	84.4
Reference speed	121

Fatigue load limit

Pu kN	2.1
-------	-----

Basic load ratings KN

dynamic C kN	1.1
static Co kN	64

Basic design bearing

B mm	82
D mm	138
d mm	143

Basic design bearing

	2
--	---

Designations

Universally matchable bearing	1
-------------------------------	----------